

JiVS-FINserv Real Estate Solution Bundle

JiVS & FINserv JOIN FORCES TO SIMPLIFY AND ACCELERATE YOUR MOVE TO SAP S/4HANA RE-FX

Simplify and accelerate your transition to SAP S/4HANA RE-FX – on-premise or on public or private Cloud. The JiVS-FINserv solution bundle provides best-in-class consulting and software to firms in the finance and real estate sectors – driving a fast and low-cost migration to the new SAP software generation.

Why?

- Reduce costs and effort:
 - o Reduce TCO for SAP S/4HANA RE-FX by up to 25%
 - o Reduce data migration effort by 50%
 - o Reduce operational costs by up to 80%
- Accelerate and simplify your transformation to an intelligent enterprise:
 - o Only migrate the necessary data
 - o Ensure seamless access to historical SAP RE-FX and FI/CO data
 - o Accelerate data load from all key source systems
 - o Achieve optimal data quality for a better customer experience
- Leverage the expertise of a leading consulting team in SAP RE-FX and FI/CO

“Over a period of ten years, we have saved around one million Euro in operating costs. That adds up to approximately a third of what it costs to run our SAP systems in the Real Asset division – and all this after retiring just one system. Using the JiVS platform to decommission systems also supports risk and compliance management, as access to legacy data is guaranteed for the full duration of the legal retention period. Storing data in Switzerland is also an advantage, as it eases compliance with regulatory requirements for Swiss legacy data.”

Urs Hutter, Senior Project Manager Real Assets IT, AXA IM

DATA MIGRATION FROM SAP ECC 6.0 RE-FX TO SAP S/4HANA RE-FX

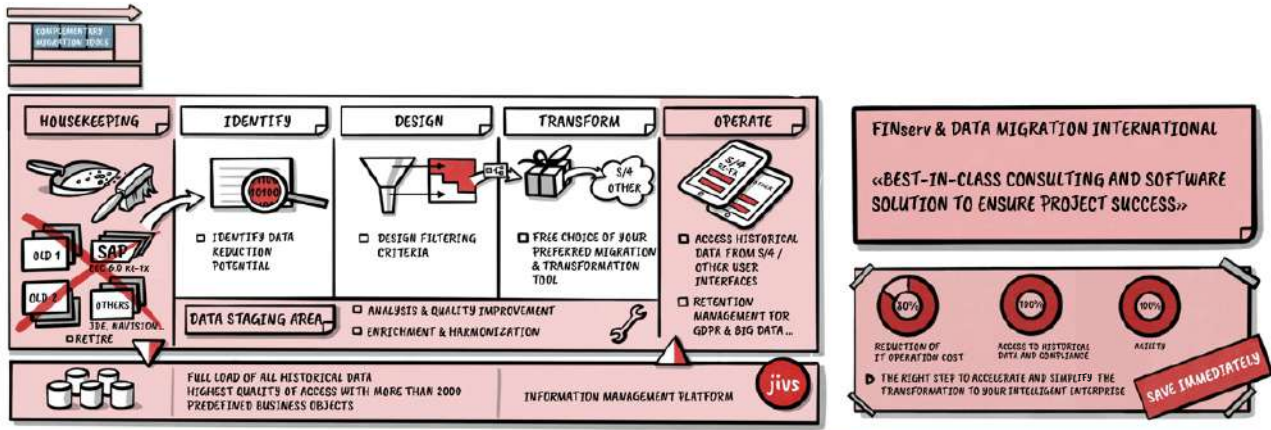

CHALLENGE	SOLUTION	BENEFIT
<ul style="list-style-type: none"> SOURCE SAP ECC RE-FX & TARGET SAP S/4HANA RE-FX LIMITED MIGRATION SUPPORT BY SAP FOR RE-FX SEVERAL CHANGES IN THE NEW RE-FX STRUCTURE USUALLY 80% OF THE DATA IS HISTORICAL OR OBSOLETE MANY DUPLICATES AND DATA IN BAD QUALITY COSTS FOR IN-MEMORY TECHNOLOGY IS VERY HIGH LACK IN DATA QUALITY RISK-FREE MIGRATION ON TIME AND BUDGET 	<ul style="list-style-type: none"> REDUCING DATA VOLUME TO BE MIGRATED BY 80% THROUGH SEPERATION OF HISTORICAL AND OPERATIONAL DATA FAST DATA LOAD FROM ALL KIND OF SOURCE SYSTEMS COMMON BUSINESS OBJECT BASED ANALYSIS, FILTERING, CLEANSING, ENRICHMENT, IMPROVEMENT OF DATA ACROSS ALL DATA SOURCES HISTORIZATION OF LEGACY SYSTEM 	<ul style="list-style-type: none"> SIMPLIFY TRANSFORMATION TO SAP S/4HANA RE-FX REDUCED TCO BY 25% FOR SAP S/4HANA RE-FX ONLY NEEDED DATA IN BEST QUALITY LOWER EFFORT UP TO 50% FOR THE DATA MIGRATION ELIMINATE OLD LEGACY SYSTEMS AND REDUCE OPERATIONAL COST UP TO 80% SEAMLESS ACCESS TO HISTORICAL DATA

SOLUTION AND CONSULTING PORTFOLIO FINserv & PARTNER JIVS

- Migration to SAP S/4HANA
- Real Estate Asset and Portfolio Management
- Rightsizing / Move to the Cloud
- Asset und Portfolio Management
- Monitoring und Reporting
- Building Rating
- Application Retirement/Historization
- Mobile Management Cockpit
- Commercial Building Management
- IFRS 16 Rating
- Technical Building Management
- Plan Integration and Graphical Visualization
- Data Quality and Improvement
- M&A
- GDPR and Compliance/Retention Management
- Correspondence Management
- Docking of Rental Portals, Migration Programs

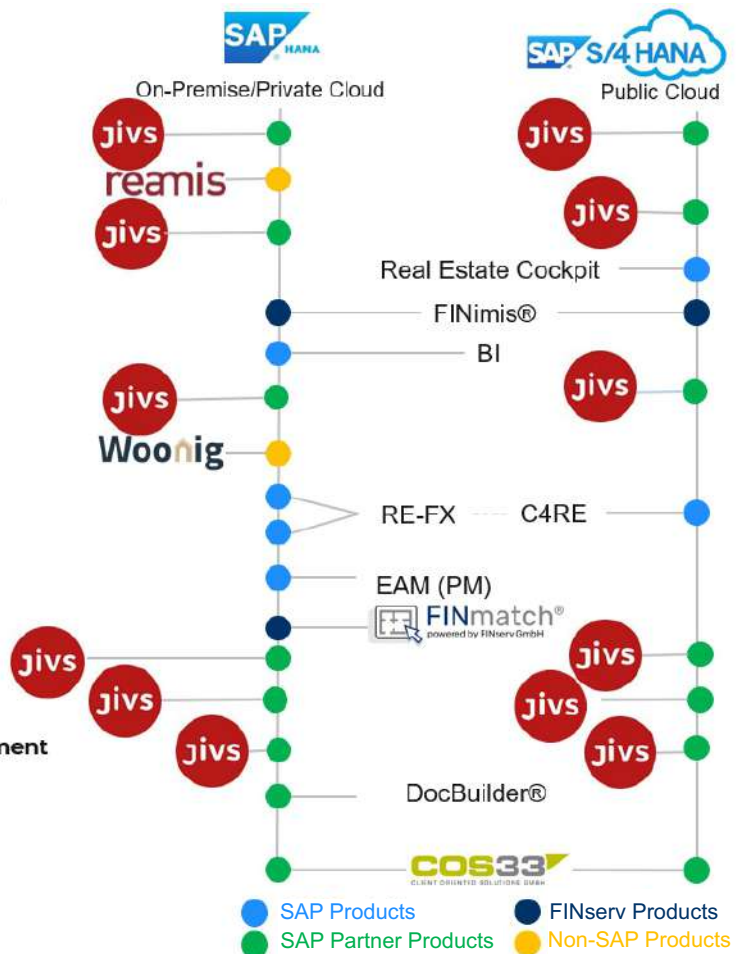

Some Customer References:



About Data Migration International:

Data Migration International has been a leading specialist in system decommissioning for more than 20 years. Its flagship product, the JiVS Information Management Platform (IMP), manages the entire lifecycle of corporate data independently of existing systems and applications. JiVS IMP enables customers to reduce operational costs by 80%, and system migration effort by 50%, while guaranteeing 100% compliance and access to information. Numerous customers like ABB, ABInBev, Alstom, RUAG, AXA, General Electric, Commerzbank and SBB benefit from JiVS IMP's cost efficiency, flexibility and agility. More information about the company and its solutions is available at www.jivs.com

Contact:

Tobias Eberle

Data Migration International

tobias.eberle@dm-international.com

www.jivs.com

About FINserv GmbH:

FINserv's mission is to optimize business processes for some of the most iconic brands in finance and real estate. We strive to make companies more efficient so they can drive innovation and deliver a better customer experience. We believe in customer collaboration to deliver innovation and knowhow to make digital transformation a reality – and help our customers to be more agile and successful.

Our focus and expertise lie in finance and real estate management, delivering best-in-class IT solutions that drive value and make companies the best-run in the industry.

We are a young and fast-growing consulting enterprise supporting some of the leading brands in the finance and real estate business. Our expertise in the integration of real estate and finance processes is unparalleled in the industry.

Contact:

Andy Fink

FINserv GmbH

andy.fink@finserv.ch

www.finserv.ch